



PETROLEUM 60

1-1/4" x 1" End Suction Centrifugal Pumps

The Petroleum 60 End Suction Centrifugal Pump is engineered for high efficiency in transferring petroleum-based liquids. This series includes three models – SO 60, SG 60, and SE 60 – each designed to accommodate different operational requirements. Built for compatibility with 56C and 145TC frame electric motors, the Petroleum 60 line also supports PumpAKs® configurations, offering added flexibility for diverse applications.

Known for its durability and dependable performance, the Petroleum 60 pump delivers a maximum flow of up to 65 GPM (14.73 m³/h) and a head capacity reaching 115 feet (35 m). These capabilities ensure fast and efficient fluid movement, making the pump an excellent choice for industrial, agricultural, marine, and OEM environments.

The Petroleum 60 Pump is available in three distinct models: SE, SG and SO:

Model SE Pumps - Compatible For Ethanol & E 85

Model SG Pumps - Compatible For Gasoline, Kerosene, Avgas & Jet Fuel

Model SO Pumps - Compatible For BioDiesel, Fuel Oil & Diesel

SPECIFICATIONS:

Suction / Discharge	1-1 /4" x 1" NPT
Flow	Up to 65 GPM (14.73 m ³ /h)
Head Feet	Up to 115' (35 m)
Impeller	SE 60 - enclosed cast iron SG 60 - enclosed aluminum SO 60 - enclosed cast iron
Motor	Up to 3 HP (2.2 kW)
Drive Options	Close coupled 56C Close coupled 145TC Hydraulic motor .37 cu. in. (6.1 cm ³) Hydraulic motor .45 cu. in. (7.4 cm ³) Hydraulic motor .58 cu. in. (9.5 cm ³) PumpAK® (without motor)
Seal	SE 60 - Type 2 viton/carbon/silicon carbide/SS SG 60 - Type 2 viton/carbon/silicon carbide/SS SO 60 - Type 21 viton/carbon/niresist/SS
Mounting Options	SE 60 - Explosion proof Class 1 Group D SG 60 - Explosion proof Class 1 Group D SO 60 - TEFC
Compatible For	SE 60 - Ethanol, E 85 SG 60 - Gasoline, Avgas, Kerosene, Jet A/8 SO 60 - Biodiesel, Fuel Oil, Diesel

Features

- Non-spark clamp

Application:

- Agricultural
- Industrial
- Marine
- OEM



An Ingersoll Rand Business

PETROLEUM 60

PERFORMANCE CURVES

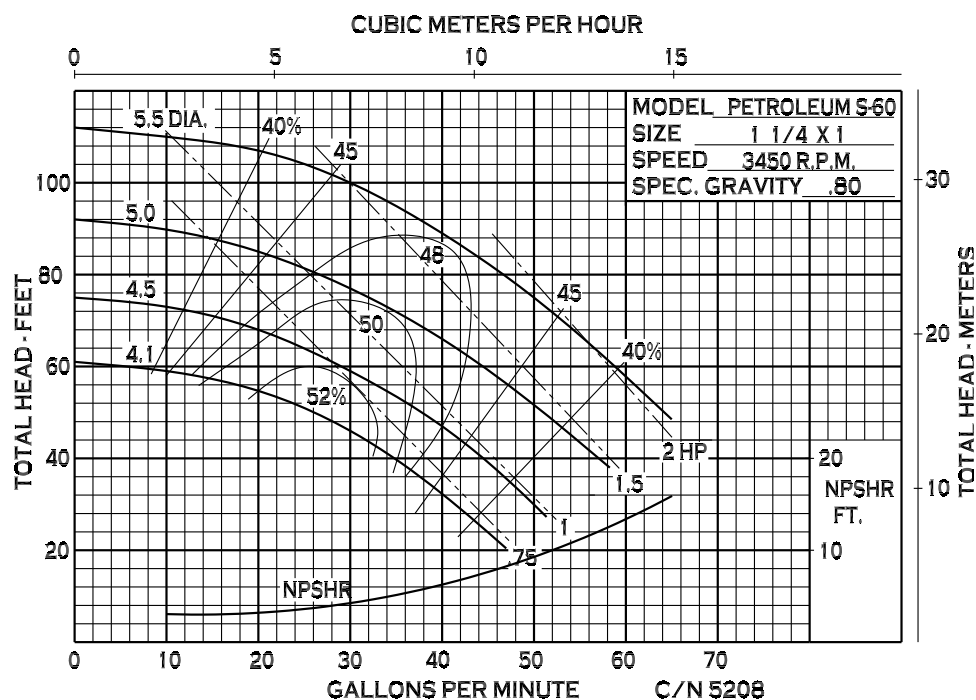

12500 South Pulaski Road
Alsip, IL 60803, USA
Phone (800) 563-8006

DIMENSIONS

CLOSE COUPLED - ELECTRIC MOTOR

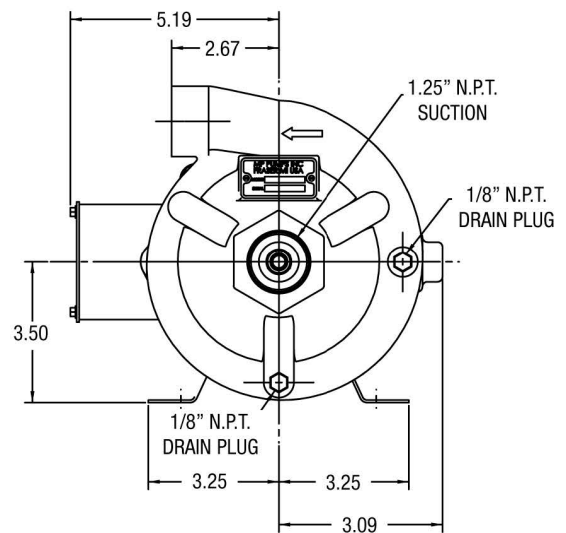
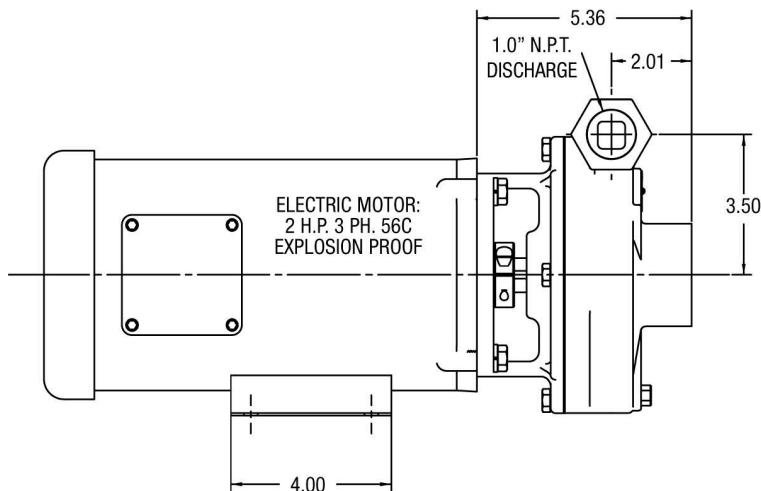
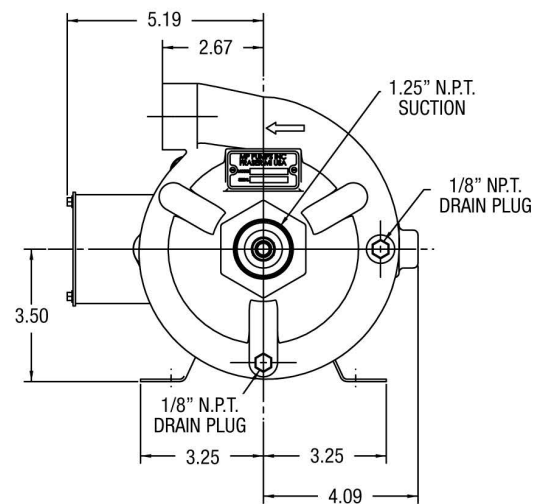
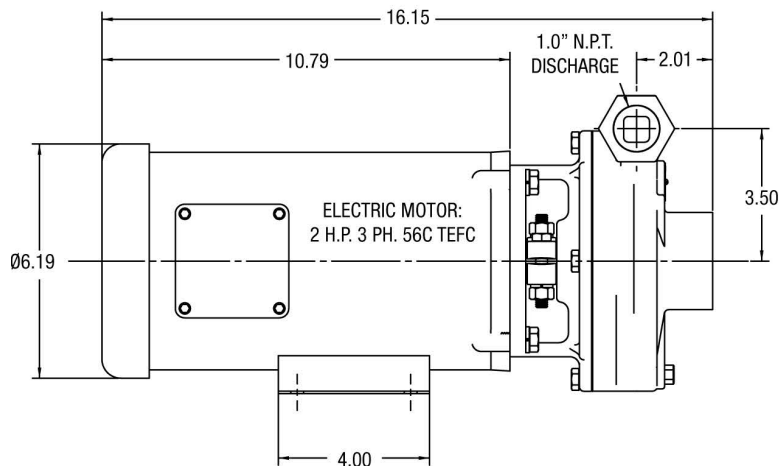

* For complete parts lists and troubleshooting guidance, please refer to the MP Pumps Installation Operation & Maintenance (IOM) Manual.

DIMENSIONS

CLOSE COUPLED - ELECTRIC MOTOR

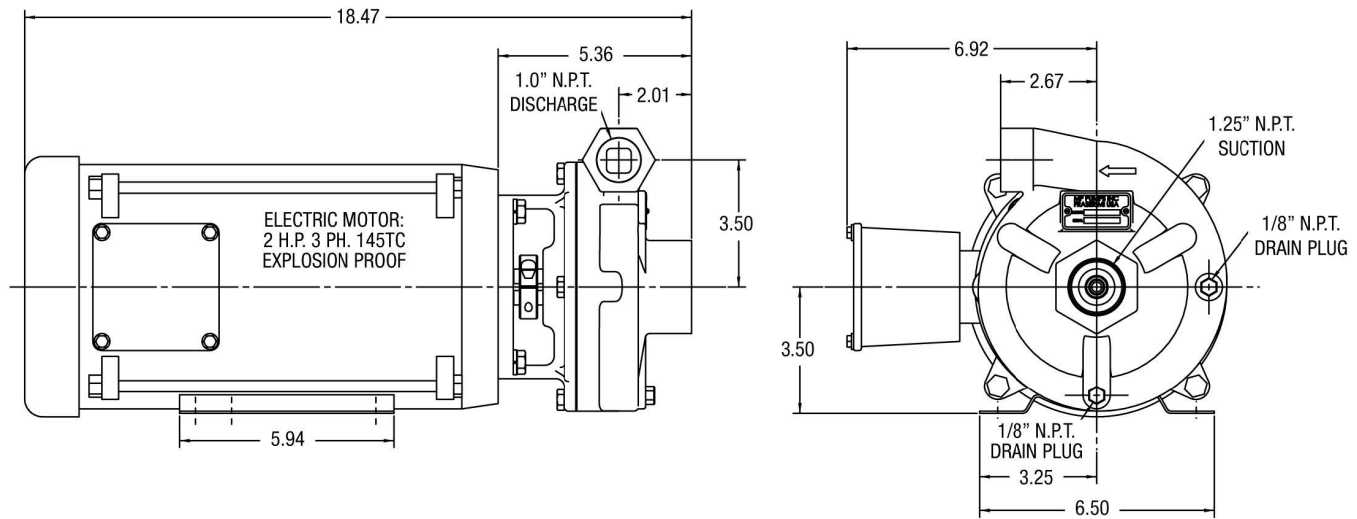

* For complete parts lists and troubleshooting guidance, please refer to the MP Pumps Installation Operation & Maintenance (IOM) Manual.